

# BROADWOOD BUSINESS PARK

2452 W BIRCHWOOD AVE • MESA, AZ 85202



- 11-building industrial center
- 156,197 total square feet
- Centrally located: Under fifteen minutes to Chandler, Gilbert, Tempe, and Scottsdale. 10 minutes to Mesa downtown, 14 minutes to Sky Harbor Airport
- Close proximity to AZ-101, AZ-202, & US-60 Freeways
- Parking Ratio: 2.02/1,000 SF

## Property Summary

|                      |                |
|----------------------|----------------|
| <b>AVAILABLE SF</b>  | 5,919-5,919 SF |
| <b>BUILDING SIZE</b> | 156,154 SF     |
| <b>MARKET</b>        | Mesa           |

**For more information, please contact:**

### **RICKY BORANE**

LEASING MANAGER  
BKM MANAGEMENT COMPANY  
P. 602.362.0803  
E. RBORANE@BKMMGMT.COM

### **GOLDEN ST. JOHN**

LEASING AGENT  
P. 602.222.5110  
E. GOLDEN.STJOHN@COLLIERS.COM

# BROADWOOD BUSINESS PARK

2452 W BIRCHWOOD AVE • MESA, AZ 85202

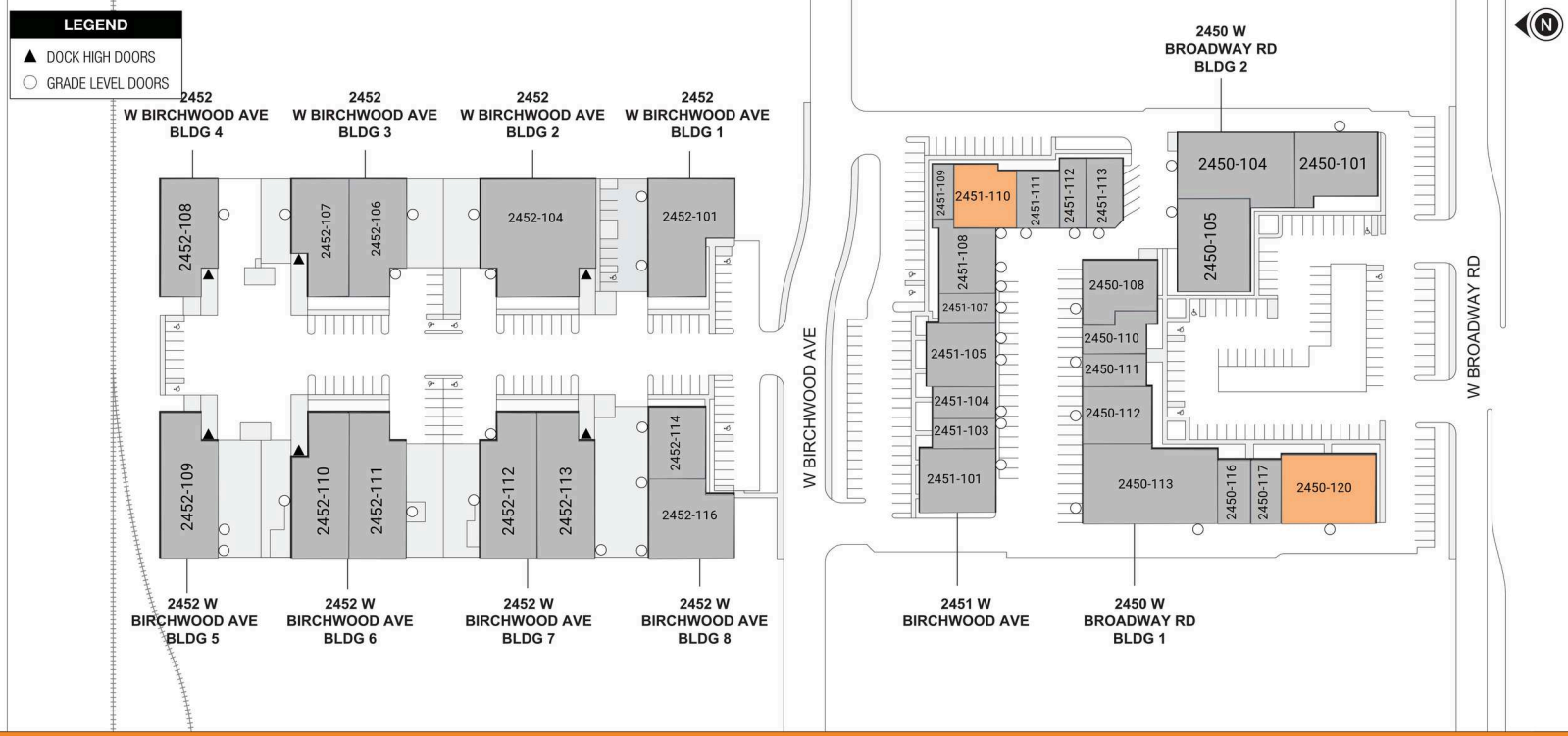

■ AVAILABLE ■ OCCUPIED

## Available Units

| BUILDING | SUITE    | TOTAL SIZE | OFFICE SIZE | OFFICE % | TYPE | CLEAR HT | GL | DL | RATE |
|----------|----------|------------|-------------|----------|------|----------|----|----|------|
| N/A      | 2450-120 | 5919       | 5919        | 100      | N/A  | 10       | 1  | 0  | N/A  |
| N/A      | 2451-110 | 3500       | 1200        | 34       | N/A  | 12       | 1  | 0  | N/A  |

# BROADWOOD BUSINESS PARK

2452 W BIRCHWOOD AVE • MESA, AZ 85202



NEARBY AMENITIES

# BROADWOOD BUSINESS PARK

2452 W BIRCHWOOD AVE • MESA, AZ 85202

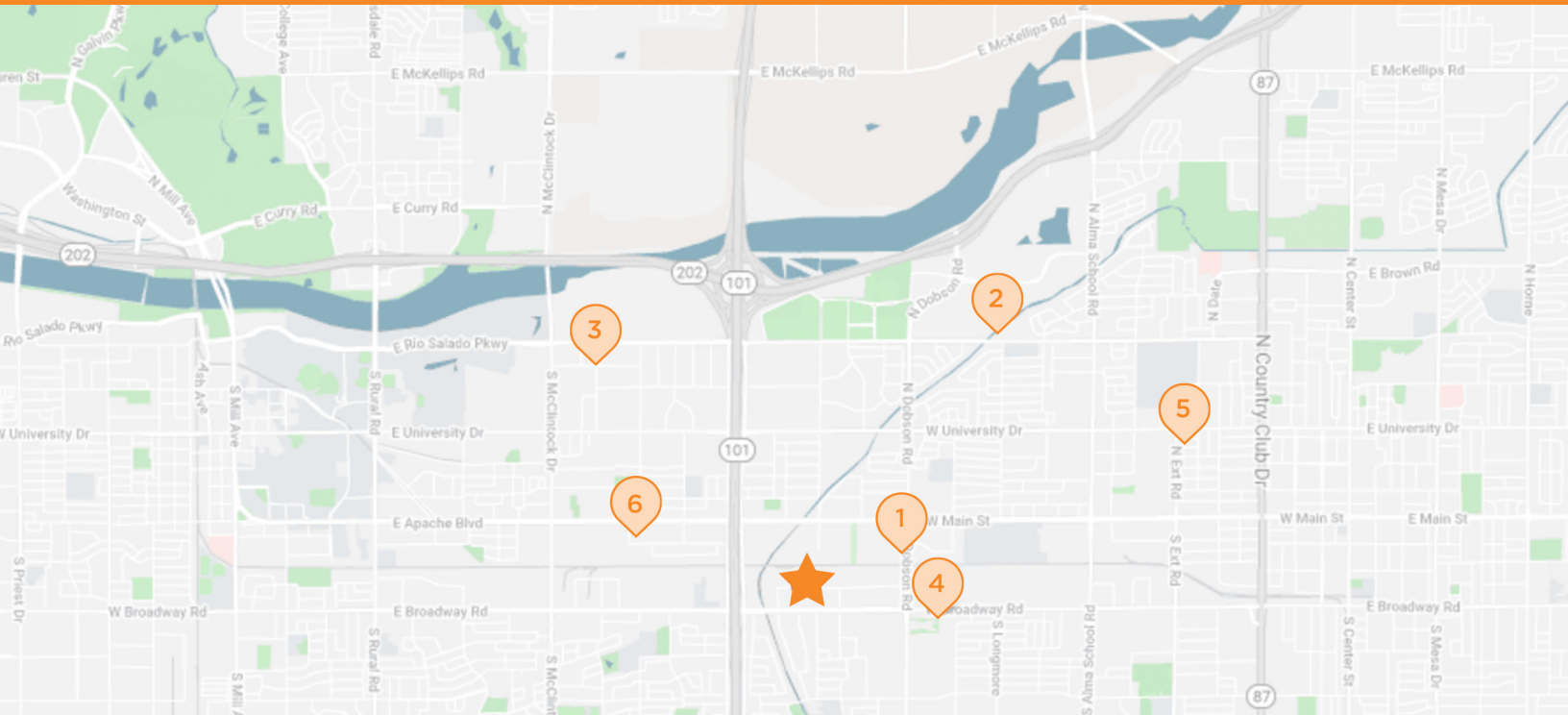

## BROADWOOD BUSINESS PARK

2452, 2450, 2451 W. Birchwood Ave; 2450 W. Broadway Road, Mesa, AZ 85202



### CHASE BANK

28 S Dobson Road  
Mesa, AZ



### WALMART

857 N Dobson Road  
Mesa, AZ



### TARGET

1800 E Rio Salado Pkwy  
Mesa, AZ



### KOREATOWN

1832 W Broadway Road  
Mesa, AZ



### FEDEX SHIPPING

746 W University Drive  
Mesa, AZ



### US POST OFFICE

1962 E Apache Blvd  
Mesa, AZ